

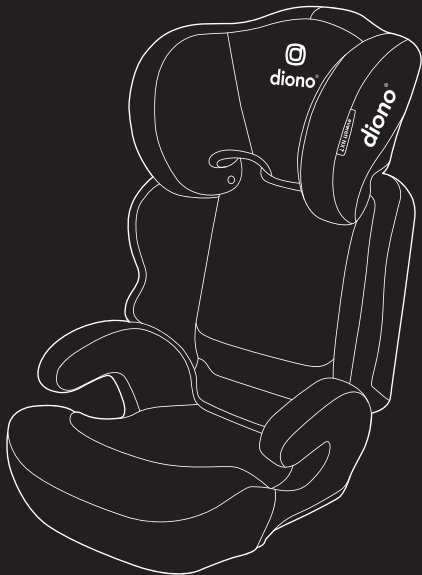

everett NXT fix

High Back Booster designed
to grow. Built to last.



IMPORTANT READ INSTRUCTION MANUAL
before using this child restraint

Important

Before using your child seat, ensure to review and familiarise yourself with the features and functions of the child seat by reference to this user manual.

Follow the instructions to the letter and keep them for future reference. The instruction manual can be stowed inside a zip pocket on the back of the backrest.

This child seat has been designed, tested and approved for use in groups 2 and 3, according to the European Standard ECE R 44/04.

| GROUP | CHILD'S WEIGHT | APPROX CHILD'S AGE |
|-------|----------------|--------------------|
| 2 | 15 to 25 kg | 3 to 7 years |
| 3 | 22 to 36 kg | 5 to 12 years |

This child seat offers a variety of installation options. The following tables indicate the types of installation for the respective groups:

| GROUP | INSTALLATION METHOD | CHILD INSTALLATION | HOMOLOGATION |
|-------|-----------------------|--------------------|----------------|
| 2 + 3 | vehicle belt | vehicle belt | universal |
| 2 + 3 | vehicle belt + isofix | vehicle belt | semi universal |

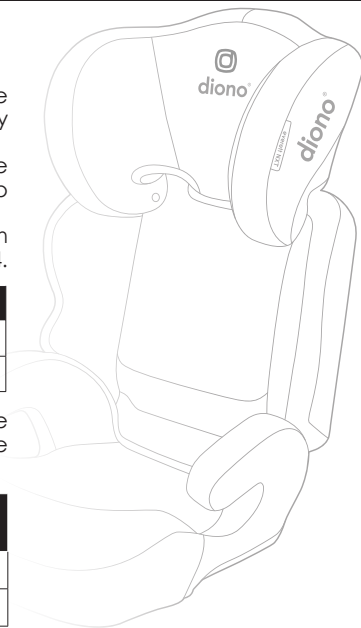

NOTICE

Groups 2 and 3 (from 15 to 36 kg) – securing with vehicle belt

1. This is a "Universal" child restraint. It is approved to Regulation No. 44, 04 series of amendments, for general use in vehicles and it will fit most, but not all, car seats.
2. A correct fit is likely if the vehicle manufacturer has declared in the vehicle handbook that the vehicle is capable of accepting a "Universal" child restraint for this age group.
3. This child restraint has been classified as "Universal" under more stringent conditions than those which applied to earlier designs which do not carry this notice.
4. Only suitable if the approved vehicles are fitted with 3 point safety belts with retractors approved to UN/ECE Regulation no. 16 or other equivalent standards.
5. If in doubt, consult either the child restraint manufacturer or the retailer.

Groups 2 and 3 (from 15 to 36 kg) – securing with vehicle belt and isofit connectors (Semi Universal – See fitting list)

1. This child restraint is classified for Semi-universal use and is suitable for fixing into the seat positions of the cars listed in the fitting list annexed to this manual. Seat positions in other cars may also be suitable to accept this child restraint.
 2. Only suitable if the approved vehicles are fitted with 3 point safety belts with retractors approved to UN/ECE Regulation no. 16 or other equivalent standards.
 3. If in doubt, consult either the child restraint manufacturer or the retailer.
- **Warning: for groups 2 and 3 fixed with the isofit system: always use the points together with the vehicle's safety belt. Do not fix the child seat by means of the isofit attachment points only.**

IMPORTANT INFORMATION

Safety

- **Warning:** for groups 2 and 3 fixed with the isofix system: always use the isofix system together with the vehicle's safety belt. Do not fix the child seat by means of the isofix attachment points only.
- **Warning:** incorrect fitting or use of the child seat may seriously affect the safety of the child.
- **Warning:** check the road traffic regulations in the country where you are travelling. The use of your child seat may be restricted.
- **Follow** precisely the user instructions.
- **Do not** make any changes to the child seat, as this could result to an unsafe situation.
- **Do not** fit any accessories, spare parts or components not supplied or approved by the manufacturer.
- **Install** the child seat so that its rigid items and plastic parts are not liable, during everyday use of the vehicle, to become trapped by a movable seat or in a door of the vehicle.
- **Do not** leave the child unattended in the child seat.



- **Do not** leave the child seat in the vehicle when the vehicle is parked in the sun: steel and plastic parts of the child seat may become very hot.
- **Make sure** that any luggage or other objects liable to cause injuries in the event of a collision are properly secured. All passengers must wear safety belts.
- **Secure** the child seat to the vehicle seat even when the seat is not in use.
- **Periodically check** the condition of the child seat. Replace the child seat if it shows signs of breakage or wear and tear.
- **Do not** use the child seat if any parts are broken or missing.
- **Use exclusively** manufacturers spare parts.
- The covers are an integral part of the child seat: the seat **must not** be used without the covers. The covers must only be replaced with manufacturers replacement covers.

In the event of an accident

- All passengers **must know** how to take the child out of the seat.
- **Replace** the child seat after an accident: it may have suffered damage that is not visible on the outside.

Comfort

- When the child seat is used on the rear seat of the vehicle, **make sure** there is enough room for the child's feet. Move the front seat forward slightly if necessary. Take frequent breaks on long journeys so the child has a chance to move about.

PREPARATORY WORK

Components of the child seat

Identify the components of the child seat before using it.

- 1 headrest
- 2 backrest
- 3 belt guide
- 4 seat base
- 5 isofit locking arms
- 6 isofit locking button
- 7 headrest adjustment handle
- 8 instruction manual
- 9 isofit adjustment button

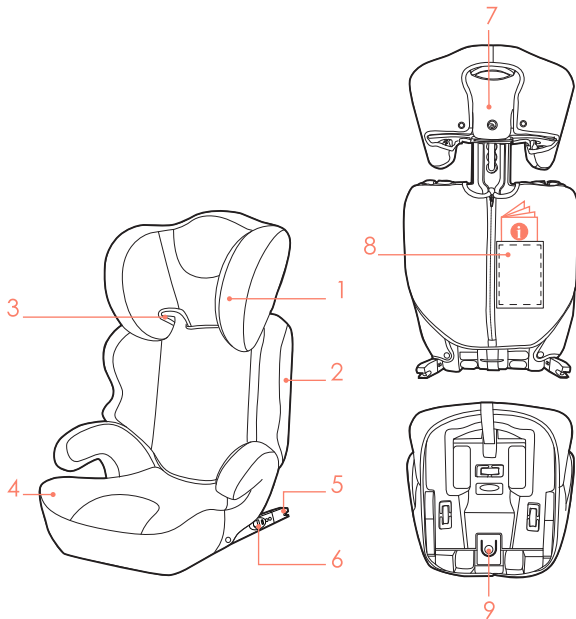

Adjusting the headrest height

- **Caution:** adjust the height of the headrest before fitting the child seat in the vehicle seat.
- **Caution:** adjust the headrest so that there is a space two fingers wide between the headrest and your child's shoulder.

Grip the adjustment handle on the back of the headrest and pull it out and upwards to unlock the headrest.

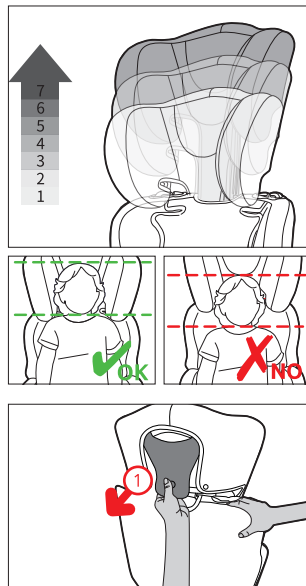

Move the headrest to the desired height.
Release the adjustment handle to lock the headrest at the desired height. You will hear a **CLICK** sound.

- **Warning:** After having released the handle, check that the headrest is locked in the new position.

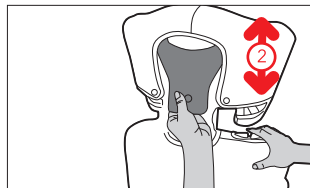

USING THE CHILD SEAT

Installing the child

Position the child seat on the vehicle seat giving priority to a rear seat position. Use of the front seat position may differ in certain countries. Refer to the highway code of the country where you are travelling.

- **Warning:** it is recommended to install the child seat in a rear seating position wherever possible.

Installation with isofix connectors (optional): this child seat is suitable for fixing into the seat positions of the vehicles listed in the fitting list annexed to this manual.

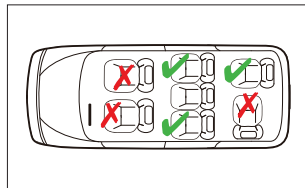

- **Warning:** always use the isofit connectors together with the vehicle safety belt. Do not fix the child seat by means of the isofit attachment points only.
- **Warning:** Do not put anything between the child seat and the vehicle seat.
- **Warning:** in case of use in vehicles fitted with rear safety harnesses with integrated airbags (inflatable seat belts), the interaction between the inflatable portion of the seat belt and the child restraint system can cause serious injuries or death.

Place the child seat facing in the direction of travel on the vehicle seat.

Installation with isofit connectors (optional)

If your vehicle is not equipped with isofit insert guides, clip the two insert guides which are included with the seat.

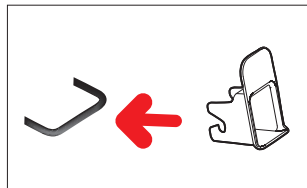

TIP: the isofix attachment points are located between the surface and the backrest of the vehicle seat.

Push the isofix release button and rotate the isofix connectors.

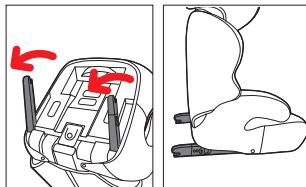
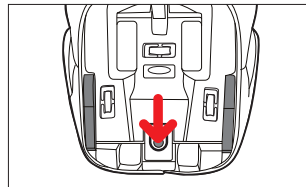
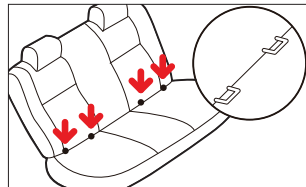

Grasp the child seat with both hands and slide the two locking arms into the insert guides until both isofix connectors engage with a "click" sound on both sides.



Check that the green safety buttons are visible on both sides.

Push the child seat towards the backrest to apply firm, even pressure on both sides.

Shake the child safety seat to make sure it is safely attached and re-check the green safety buttons to make sure that both of them are completely green.

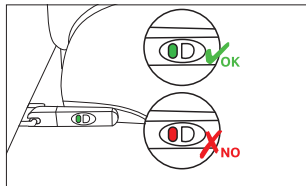

Place the child in the child seat. Ensure they are as far back and upright as possible.
Pull out the vehicle seat belt and guide it in front of your child to the vehicle seat buckle.

- **Warning: The vehicle seat belt routing positions are marked in red. Do not route the vehicle seat belt in positions other than those indicated.**

Engage the buckle tongue in the vehicle seat buckle.
Place the diagonal seat belt section and lap belt section in the belt guide under the armrest of the child seat on the side of the vehicle seat belt buckle.

- **Warning: position both lap and diagonal belt sections under the armrest. Do not position them over the armrest.**

Place the lap belt section on the other side of the child seat in the belt guide under the armrest.
Guide the diagonal seat belt section into the belt guide of the headrest.

Tip: If the backrest conceals the belt guide on the headrest, adjust the headrest upwards. The diagonal seat belt section can now be easily inserted. Now return the headrest to the proper height.

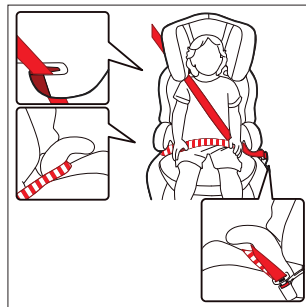
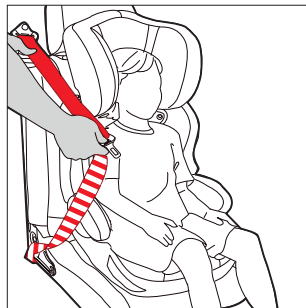

Pull the diagonal section of the vehicle belt to tighten it.

- **Warning:** Make sure that the diagonal seat belt section runs over your child's chest, and not in front of her or his neck.
- **Warning:** During the journey periodically check that the child has not freed itself from the child seat.
- **Warning:** the lap portion of the seat belt must be positioned as low as possible on your child's hip, so that the pelvis is firmly engaged.
- **Warning:** check that the seat belt restraining the child is not twisted
- **Warning:** check that the seat belt is adjusted to the child's body.

Releasing the child from the seat

Release the child seat belt, unthread it from the child seat and allow it to retract.

- **Warning:** secure the child seat with the vehicle safety belts even when there is no child in it, to prevent the child seat to moving around in the vehicle while driving.

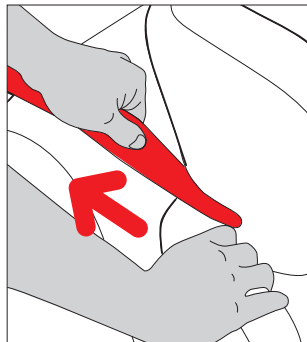

Removing the child seat

To release the isofix connectors, pull the red button, first on one side, then on the other.

Release the vehicle seat belt, unthread it from the child seat and allow it to retract.
Take the child seat away from the vehicle seat.

Rotate the isofix locking arms under the seat shell.

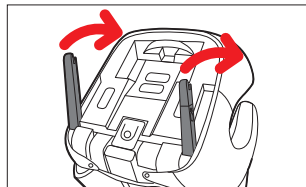
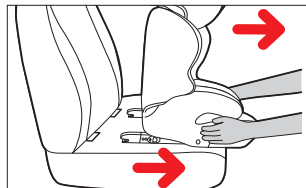
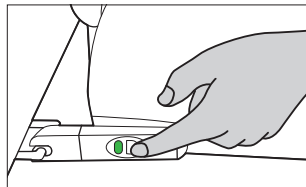

CARE AND MAINTENANCE

Cleaning

Clean plastic parts with a wet cloth.
Do not use harsh cleaning agents. Never use chemical cleaning or bleaching agents.

Cover

Take the covers off completely to wash them.
Follow the washing instructions reported on the label attached to the fabric.
Wash plastic parts using warm water and soap. Do not use aggressive cleaning agents.

- **Warning: The covers are an integral part of the child seat: the seat must not be used without the covers. The covers must only be replaced with manufactures replacement covers.**

Removing the cover

Disassemble the seat base from the back support by pushing down on the seat base whilst pushing the back support backwards until the two projecting tabs on the back support disconnect with the openings in the seat base.

Remove the cover from the back support by unhooking the elastic sections around the projection tabs, then pull the cover off over the side wings and remove from the back support shell.

Unhook the elastic sections under the shoulder sections of the headrest and pull the cover up over the top of the headrest shell.

Remove the covers from the seat base by unlock the buttons on covers and seat base shell.

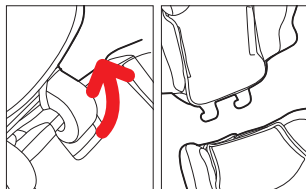
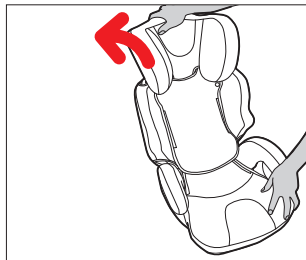



diono

#MadeOfSeattle



Made in China

© 2018 Diono UK 2nd Floor | Dale House | 35 Dale Street |
Manchester | M1 2HF | United Kingdom
#DI-000242

diono.com